



PROFESSIONAL LAUNDRY

PROFESSIONAL DRYERS CONCEPT / ECONOMIC LINE SRP-08/10 M / SCP-10 M



CHARACTERISTICS

OUTSTANDING FEATURES

- M PROGRAMMER: selection of time and temperature, user friendly and versatile (OPL or coin laundry version)
- Reduced drying times (less than 45 minutes)
- 6,75 kw heating, option 4,5 kW (4,5 kW in SCP)

VERSATILITY

- OPL <-> COIN
Standard models can be programmed as OPL or coin laundry version, central pay, etc.
- SINGLE <-> STACKED
Models can be stacked on top of a washer or on another dryer. Control panels can be assembled between both drums for better ergonomics. (Except SCP Model)
- Ideal for multiple solutions: hotels, hostels, campings, coin laundries, facility services (mops), gyms, etc.

EFFICIENCY

- Optimised airflow
- Wide fluff filter as drawer
- Efficient design

ROBUSTNESS

- Outer casing in grey skinplate (White lacquered in SCP model)
- Robust aluminium big door
- Drawer as fluff filter (not in the door but as a specific drawer)
- Industrial fan and powerful airflow
- Sturdy construction of the dryer structure and panels

OTHERS

- Galvanized drum
- FULL SCREEN FILTER: drawer fluff filter, not in the door.
- New gas heated models.
- CE approved product

OPTIONS

- Stainless steel outer casing (Except SCP Model)
- AISI 304 stainless steel drum (Except SCP Model)
- Reverse door opening
- Control panel in the bottom (stacked dryer)
- Plinth for better ergonomics
- Complete container order + compact packing
- Maritime voltage 440V III 50/60 Hz No neutral
- Coin/token kit

TECHNICAL DATA

PROFESSIONAL DRYERS | CONCEPT / ECONOMIC LINE | SRP-08/10 M / SCP-10 M

| | UNIT | SRP-08 M | SRP-10M / SCP -10 M | | |
|--|------------|---------------|-----------------------------|-----------------------------|---------------|
| CAPACITY & DRUM | | | | | |
| Capacity 1:20 | kg | 8 | 10 | | |
| Volume (litres) | l | 160 | 200 | | |
| Drum diameter Ø | mm | 590 | 590 | | |
| Drum depth | mm | 585 | 690 | | |
| DOOR | | | | | |
| Height center door | mm | 554 | 554 | | |
| Height base door | mm | 320 | 320 | | |
| Door diameter | mm | 480 | 480 | | |
| GENERAL DETAILS | | | | | |
| M control | - | Yes | Yes | | |
| USB connection | - | No | No | | |
| Construction | - | Skinplate | Skinplate / White lacquered | | |
| Plinth | - | Opt | Opt / No | | |
| Coin laundry version | - | Yes | Yes | | |
| Noise level | dB | 62 | 62 | | |
| POWER | | | | | |
| Motor | kW | 0,37 | 0,37 | | |
| Electric heating | kW | 6,75 / 4,5 | 6,75 / 4,5 // (SCP -10 4,5) | | |
| Gas heating | kW | 6,70 | 6,70 | | |
| CONNECTIONS | | | | | |
| | | ELECTRIC | | ELECTRIC | |
| Tension 230V I+N+T 50Hz / 60Hz | Nº x mm2/A | 3 x 10 / 40A | 3 x 1,5 / 10A | 3x10 / 40A | 3 x 1,5 / 10A |
| Tension 230V III+T 50Hz / 60Hz | Nº x mm2/A | 4 x 4 / 25A | 3 x 1,5 / 10A | 4x4 / 25A | 3 x 1,5 / 10A |
| Tension 400V III+N+T 50Hz / 60 Hz | Nº x mm2/A | 5 x 2,5 / 16A | 3 x 1,5 / 10A | 5x2,5 / 16A | 3 x 1,5 / 10A |
| Fume exhaust Ø | mm | 100 | | 100 | |
| Maximum airflow | m3/hour | 300 | | 300 | |
| CONSUMPTIONS | | | | | |
| Electric heating | kW | 6,75 / 4,5 | | 6,75 / 4,5 // (SCP -10 4,5) | |
| Average propane gas consumption | kg/h | 0,45 | | 0,45 | |
| Average natural gas consumption | m3/h | 0,46 | | 0,46 | |
| DIMENSIONS / PACKING DIMENSIONS | | | | | |
| Net width / Gross width | mm | 680 / 710 | | 680 / 710 | |
| Net Depth / Gross Depth | mm | 722 / 832 | | 775 / 832 | |
| Net Height / Gross Height | mm | 1056 / 1141 | | 1.056 / 1.141 | |
| Net weight / Gross weight | kg | 89 / 101 | | 93 / 104 | |

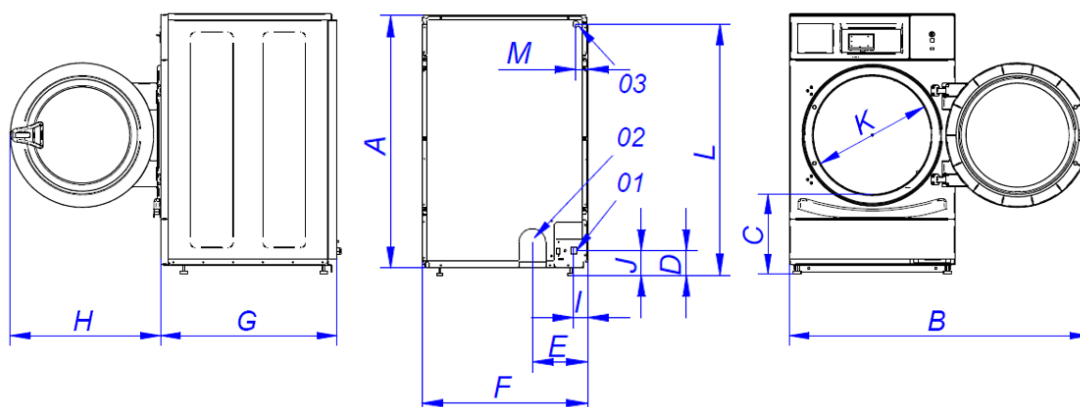

01 ELECTRICAL CONNECTION
02 EXHAUST OUTLET Ø100
03 GAS INLET 1/2"

| | A | B | C | D | E | F | G | H | I | J | K | L | M |
|------------|------|------|-----|-----|-----|-----|-----|-----|----|----|-----|------|----|
| SRP-08 | 1056 | 1227 | 320 | 140 | 226 | 680 | 722 | 615 | 57 | 91 | 480 | 1015 | 50 |
| SRP/SCP-10 | 1056 | 1227 | 320 | 140 | 226 | 680 | 722 | 615 | 57 | 91 | 480 | 1015 | 50 |