



PROFESSIONAL LAUNDRY

PROFESSIONAL DRYERS ADVANCE SRP-08/10 TP2



CHARACTERISTICS

TP2

- User friendly and totally programmable 7"
- USB Connection. Online platform free of charge for programming, telemetry, data analysis...thanks to the IoT
- Videos on display (ads, instructions, etc.)
- 37 languages
- 8 dosing signals as standard

VERSATILITY

- OPL <> COIN
Standard models can be programmed as OPL or coin laundry version, central pay, etc.
- SINGLE <> STACKED
Models can be stacked on top of a washer or on another dryer. Control panels can be assembled between both drums for better ergonomics.
- Ideal for multiple solutions: hotels, hostels, campings, coin laundries, facility services (mops), gyms, etc.
- Wet cleaning features.

CONNECTIVITY

- IoT - FagorKonnnect standard.
- Management of laundries: OPL and COIN
- Remote payment

EFFICIENCY

- Optimised airflow
- Wide fluff filter as drawer
- Efficient design

ROBUSTNESS

- Outer casing in grey skinplate
- Robust aluminium big door
- Industrial fan and powerful airflow
- Sturdy construction of the dryer structure and panels

OTHERS

- Gas or electric heated models.
- CE approved product

OPTIONS

- iDRY: humidity sensor
- Stainless steel outer casing
- AISI 304 stainless steel drum
- Reversing door opening
- Tropicalized model: protected board
- Plinth for better ergonomics
- Plinth for better ergonomics in stainless steel
- Control panel mounted below (stacked dryer)
- Order in complete container + compact packing
- Maritime voltage 440V III 50/60 Hz
No neutral
- Coin/token kit

TECHNICAL DATA
PROFESSIONAL DRYERS | ADVANCE | SRP-08/10 TP2

	UNIT	SRP-08 TP2		SRP-10 TP2	
CAPACITY & DRUM					
Capacity 1:20	Kg	8		10	
Volume (litres)	l	160		200	
Drum diameter Ø	mm	590		590	
Drum depth	mm	585		690	
DOOR					
Height center door	mm	554		554	
Height base door	mm	320		320	
Door diameter	mm	480		480	
GENERAL DETAILS					
Control TP2	-	Yes		Yes	
USB connection	-	Yes		Yes	
Construction	-	Skinplate panels		Skinplate panels	
Plinth	-	Opt		Opt	
Coin laundry version	-	Yes		Yes	
Noise level	dB	62		62	
POWER					
Motor	kW	0,37		0,37	
Electric heating	kW	6,75 / 4,5		6,75 / 4,5	
Gas heating	kW	6,7		6,7	
CONNECTIONS					
Tension 230V I+N+T 50Hz / 60Hz	Nº x mm2/A	ELECTRIC	GAS/STEAM	ELECTRIC	GAS/STEAM
Tension 230V III+T 50Hz / / 60Hz	Nº x mm2/A	3 x 10 / 40A	3 x 1,5 / 10A	3 x 10 / 40A	3 x 1,5 / 10A
Tension 230V III+T 50Hz / / 60Hz	Nº x mm2/A	4 x 4 / 25A	3 x 1,5 / 10A	4 x 4 / 25A	3 x 1,5 / 10A
Tension 400V III+N+T 50Hz / / 60Hz	Nº x mm2/A	5 x 2,5 / 16A	3 x 1,5 / 10A	5 x 2,5 / 16A	3 x 1,5 / 10A
Fume exhaust Ø	mm	100		100	
Maximum airflow	m3/h	300		300	
CONNECTIONS					
Electric heating consumption	kW	6,75 / 4,5		6,75 / 4,5	
Average propane gas consumption	kg/h	0,45		0,45	
Average natural gas consumption	m3/h	0,46		0,46	
DIMENSIONS / PACKING DIMENSIONS					
Net width / Gross width	mm	680 / 710		680 / 710	
Net Depth / Gross Depth	mm	722 / 832		775 / 832	
Net Height / Gross Height	mm	1056 / 1141		1056 / 1141	
Net weight / Gross weight	kg	89 / 101		93 / 104	
Volume	m3	0,67		0,67	

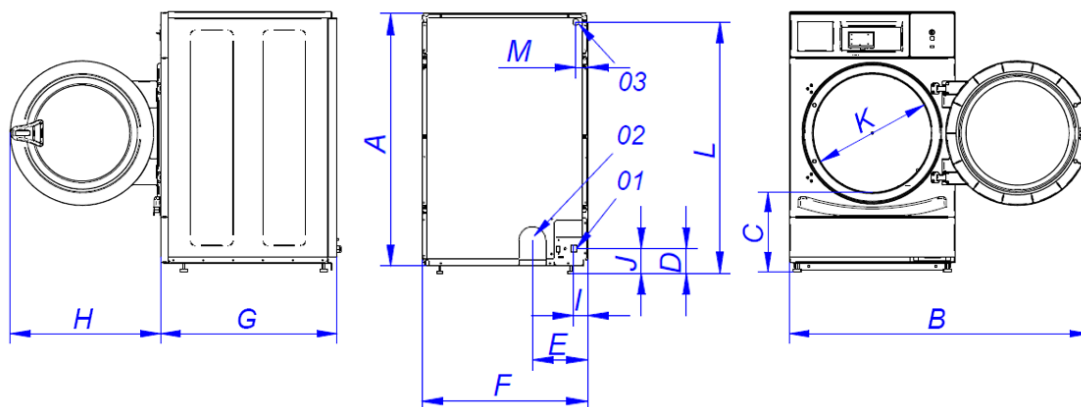

01 ELECTRICAL CONNECTION
 02 EXHAUST OUTLET Ø100
 03 GAS INLET 1/2"

	A	B	C	D	E	F	G	H	I	J	K	L	M
SRP-08	1056	1227	320	140	226	680	722	615	57	91	480	1015	50
SRP-10	1056	1227	320	140	226	680	722	615	57	91	480	1015	50