



FINISHING

PNEUMATIC PRESSES PU / PU-C / PCP / PCP-C



CHARACTERISTICS

- 2 models:
 - PU: universal buck
 - PCP: buck for collars and cuffs.
- Lower buck with steam in all models.
- Upper buck is up-steaming also.
- Optional: upper buck with polished head for laundry, without steam then.
- Work table dimensions: 1.180 x 380 x 220 mm.
- Lowering of the upper buck controlled by two push buttons.
- Steam inlet in the upper buck by push button.
- Steam inlet in the lower buck by push pedal.
- All models equipped with a vacuum unit.
- Connection: 230/400V III 50Hz

OPTIONS

- Steam generator - boiler 16 Litres (12 kW).
- Compressor unit. 2 HP.
- Group of iron + pedal.
- Spray gun for steam.
- Polished upper buck for laundry (not up-steaming).

TECHNICAL DATA

PNEUMATIC PRESSES | PU / PU-C / PCP / PCP-C

GENERAL DETAILS	U.	PU		PCP	
		WITH BOILER	WITHOUT BOILER	WITH BOILER	WITHOUT BOILER
Board dimensions	mm	1.170 x 360 x 220	1.170 x 360 x 220	940 x 160	940 x 160
Boiler capacity	l	16	-	16	-
Compressor	-	OPT	OPT	OPT	OPT
Group of Iron	-	OPT	OPT	OPT	OPT
Steam gun	-	OPT	OPT	OPT	OPT
Polished upper buck	-	OPT	OPT	OPT	OPT
POWER					
Vacuum Motor	HP	0,6	0,6	0,6	0,6
Pump Motor	HP	0,75	-	0,75	-
Compressor motor (Mod. with option)	HP	2	2	2	2
Boiler Heater	kW	12	-	12	-
CONNECTIONS					
Ø Water inlet	BSP	3/8"	-	3/8"	-
Ø Boiler exhaust (mod. with boiler)	BSP	1/2"	-	1/2"	-
Ø Steam inlet	BSP	-	1/2"	-	1/2"
Ø Condensate outlet	BSP	-	1/2"	-	1/2"
Steam pressure	BAR	4-5	4-5	4-5	4-5
Steam Consumption	Kg/h	12-20	12-20	12-20	12-20
Ø Air inlet	BSP	-	3/8"	-	3/8"
Ø Air pressure	BAR	6-7	6-7	6-7	6-7
Ø Air Consumption	NI/m	40	40	40	40
DIMENSIONS / PACKING DIMENSIONS					
Width / Width	mm	1.370 / 1.440	1.370 / 1.440	1.370 / 1.440	1.370 / 1.440
Depth / Depth	mm	1.080 / 1.110	1.080 / 1.110	1.080 / 1.110	1.080 / 1.110
Height / Height	mm	1.250 / 1.410	1.250 / 1.410	1.250 / 1.410	1.250 / 1.410
Net weight / Gross weight	kg	292 / 342	237 / 287	292 / 342	237 / 287
Gross volume	m ³	1,84 / 2,25	1,84 / 2,25	1,84 / 2,25	1,84 / 2,25
OTHERS					
Voltage	Hz	230/400V III 50-60	230/400V III 50-60	230/400V III 50-60	230/400V III 50-60
Sound level	dB	70	70	70	70

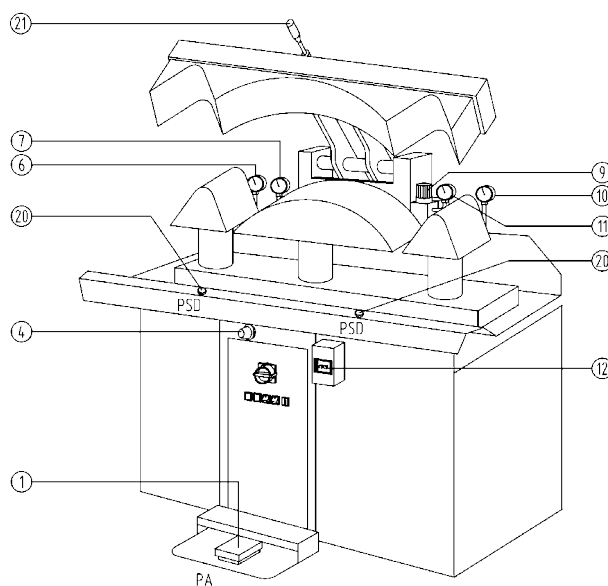
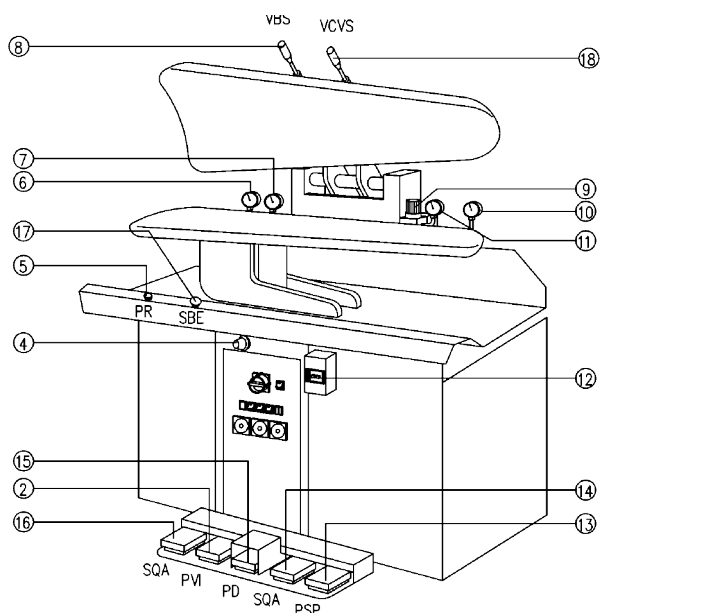

- 2. Lower plate steam pedal.
- 4. Crushing pressure regulator.
- 5. Hand guard frame reset button
- 6. Steam circuit pressure gauge 0-10 bar (optional with boiler).
- 7. Compressor pressure gauge 0/16 bar (optional with compressor).
- 8. Locking and release valve for upper plate.
- 9. Compressed air filter-regulator and lubricator unit
- 10. Crushing pressure gauge /16 bar.
- 11. Compressed air network pressure gauge 0/16 bar.
- 12. Circuit breaker (optional with compressor).
- 13. Lower plate blow-off pedal (optional).
- 14. Second lower plate suction pedal (optional)
- 15. Upper plate lowering pedal.
- 16. Lower plate suction pedal.
- 17. Emergency cycle stop button.
- 18. Upper plate steam control valve.

- 4. Crushing pressure regulator.
- 6. Steam circuit pressure gauge 0-10 bar (optional with boiler).
- 7. Compressor pressure gauge 0-16 bar (optional with compressor).
- 9. Compressed air filter-regulator and lubricator unit.
- 10. Crushing pressure gauge 0-16 bar.
- 11. Compressed air network pressure gauge 0/16 bar.
- 12. Circuit breaker (optional with compressor).
- 16. Lower platen suction pedal
- 17. Emergency cycle stop button
- 20. Upper platen lowering button
- 21. Upper platen release button